

Rancho Terra Norte,



**1227 E. County Road 82
Wellington, CO**



BSCA French Course Herding Trial

**French Course Sheep – Started, Intermediate, Advanced
Event # 2017BSCA10 April 30, 2017**

Test/Trial Hours -- 7:00AM till over

These events will be held outdoors, rain or shine.

**BSCA French Course Sheep Trials open to all AKC Registered and
ILP/PAL Dogs of breeds approved by the AKC for Herding other than
Border Collies & Kelpies.
Dogs must be 9 months or older.**

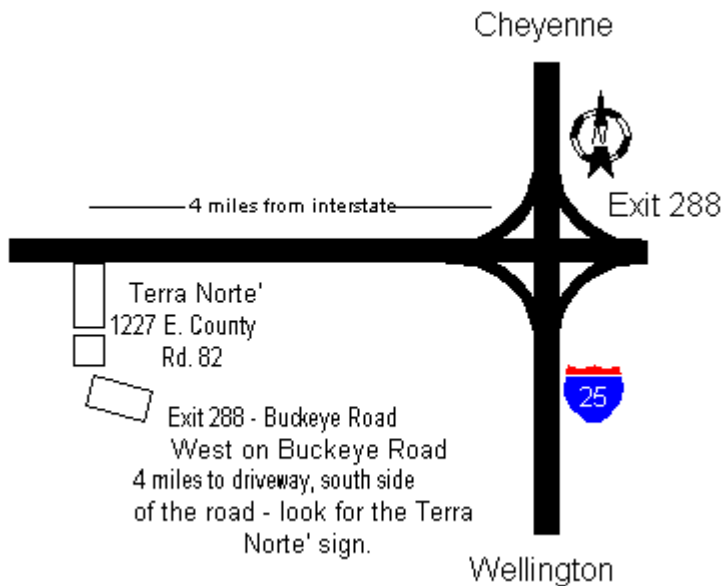

PERMISSION HAS BEEN GRANTED BY THE BELGIAN SHEEPDOG CLUB OF AMERICA (BSCA) TO HOLD THE FRENCH COURSE SHEEP TRIAL UNDER BSCA RULES AND REGULATIONS

BSCA rules for the FRENCH Course can be found at

<http://bsca.info/wp-content/uploads/2013/07/BSCAFrenchcourse.pdf>.

BSCA French Course Sheep Trials open to all AKC Registered and ILP/PAL

Dogs of breeds approved by the AKC for Herding other than Border Collies & Kelpies.

Dogs must be 9 months or older.

Entry Fees –

French Course Sheep (FS) trial classes:

\$60 pre-trial/ \$70 day of trial

(includes \$10 BSCA recording fee)

Total entry limit 12 Trial Runs each day

Day of event entries will be accepted **ONLY** if stock and/or time allows.

Stock: Sheep/Value \$200

St. Croix, woolies & mixed hair &/or woolies in a rainbow of colors.

RIBBONS WILL BE AWARDED FOR FOUR PLACES IN EACH CLASS/QUALIFYING RIBBONS TO EACH QUALIFIER

The Rocky Mountain Belgian Sheepdog Club supports the entries of this event by providing pet related items for the following:

High in Trial & Reserve High in Trial

Highest scoring - Belgian Sheepdog

Highest scoring - Other breed

A Certificate of Accomplishment for all qualifying scores

JUDGE: Ken Theus, DVM

Boerne, TX

***Trial hours are from 7:00 am to 7:00 pm each day
This event will be held outdoors regardless of weather***

Trial Secretary:

Val Manning, Rancho Terra Norte'

1227 E County Road 82

Wellington, CO 80549

(970) 391-6559 ranchoterranorte@hotmail.com

BSCA Trial committee: Debbie Courtier, Rob Coutier, Trish Edwards, Kristy Astry, and Stephanie Price

VETERINARIAN (on call):

Alice Baker-Meutin, DVM

Optimal Animal Health and Performance

7755 County Road 94 Fort Collins, CO 80524 (970)646-3600

Motels That Will Accept Dogs

Days Inn, 7860 6th Street, Wellington, CO (970) 568-0444

Days Inn, 3624 E. Mulberry, Fort Collins, CO (970) 221-5490

Fort Collins LaQuinta, 3709 E. Mulberry, Fort Collins, CO (970) 493-7800

Motel 6, 3900 E. Mulberry, Fort Collins, CO (970) 482-6466

Sleep Inn, 3808 E. Mulberry, Fort Collins, CO (970) 484-5515 (dog friendly, mention BVKC)

Mulberry Inn, I-25, Ault exit 269A, 4333 East Mulberry, Fort Collins, CO (970) 493-9000

Plaza Inn, I-25, exit 269B, 3836 E. Mullberry, Ft. Collins, CO (970)484-4660

RVs & Travel Trailer Accommodations

Space for parking of RVs and travel trailers is available but RVs must be self-contained (No RV Hookups).

The Northern Colorado Herding Cooperative will be providing concessions for purchase each day. The nearest food is 10 miles away from the trial site.

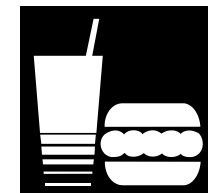

RTN—BSDC French Course Diagram

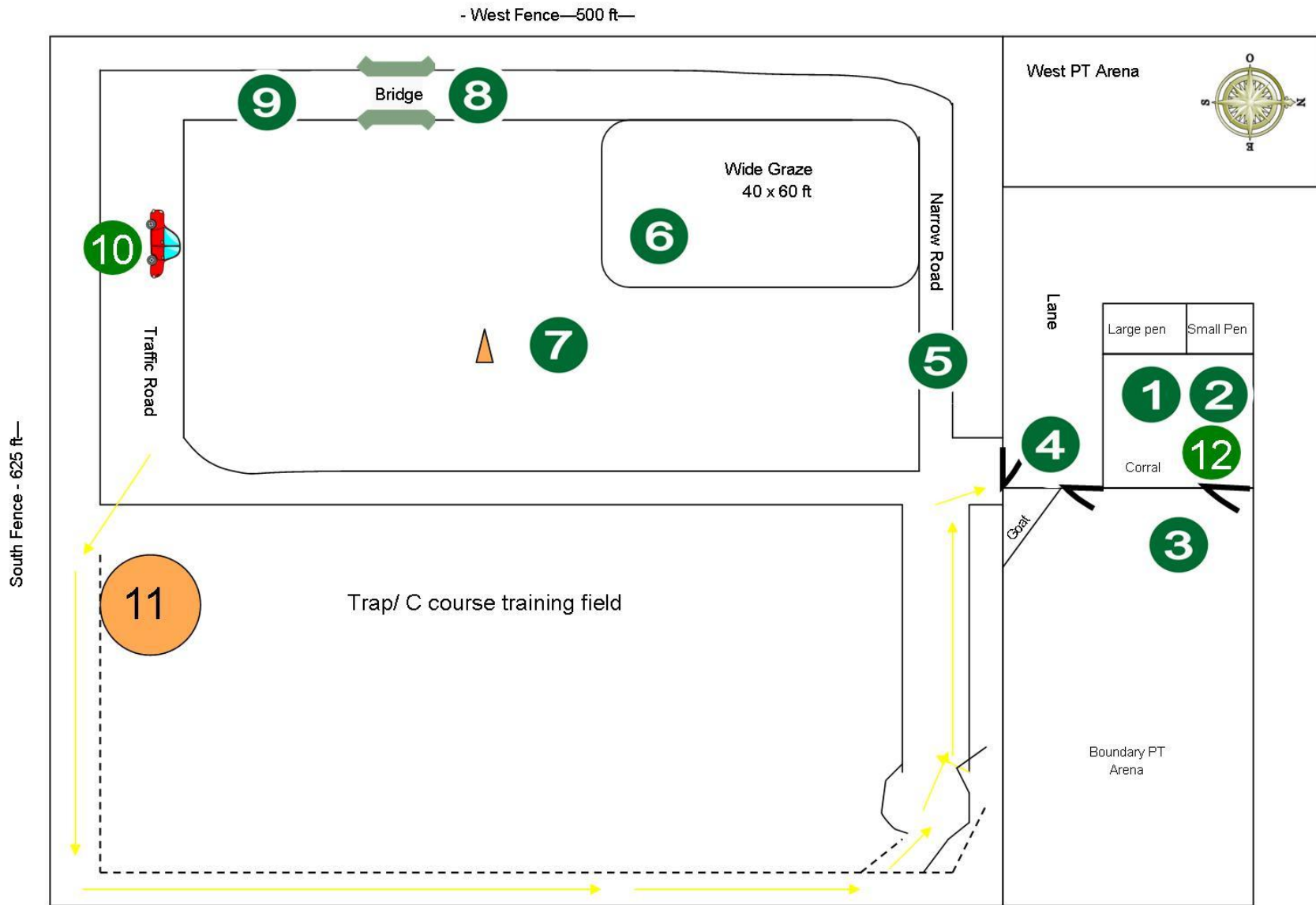

RTN – BSCA French Course Trial Course Description (Sheep)

April 30, 2017, event #2017BSCA10

Judge: Ken Theus, DVM

Sheep are contained in the corral (25 head in Started & Intermediate flock, 50 head for Advanced) – Handler and dog enters from the East gate. Dog must enter first to prevent escape of stock while handler enters. (note: due to corral construction – there will not be a jump)

1. Pen/Protection of the Handler/Examination of flock: Handler enters corral with the dog and circles the flock while the dog helps to clear a path allowing the handler to examine the flock.
2. Hold/Catching a Sheep: After the examination – the handler then walks into the flock catches and holds a sheep (by neck or leg). The dog should control the remainder of the flock.
3. Exit from the Pen: Once the stock has been inspected and the catch/hold accomplished, the handler opens the gate and exits with the flock. Flock should be held up so the handler can CLOSE the gate before proceeding on the course.
4. Difficult Passage 1: Controlled movement through gates
Handler and dog take flock around to the west gate of the PT boundary arena; dog holds the stock while the handler opens the West PT boundary gate and controls them through the gate while the handler closes the gate after the flock passes through. The handler then moves to the silver gate of the Trap. The dog assists the handler to get the stock through this gate and holds the stock while the handler closes the gate.
5. Narrow road: The handler takes the stock along the narrow road towards the wide graze area located in the northwest corner of the trap. The sheep are to stay on the road and move in a calm organized manner. Handler may take any position relative to the stock.
6. Wide Graze: Once the handler and stock reach the entrance on the west side of the graze, the stock is allowed to enter the graze and settle. The dog is expected to keep the sheep within the graze area for the duration of the graze. Graze is judged as to when stock settle and start to eat
7. Work at a distance: Advanced only – at some time during the graze, the judge will approach and the handler is to leave his dog working the graze and walk over to the judge and shake hands.
8. Gather:
 - a. ADVANCED – Following the Work at a Distance exercise, the handler moves to the handlers post and calls the dog. The handler calls the dog to gather the stock and fetch them to the handlers post and then back to the road to continue the course

- b. INTERMEDIATE – The handler is positioned at a point halfway from the graze and the ADVANCED handlers post, calls the dog to gather the stock towards the handler and then back to the road to continue the course.
 - c. STARTED – The handler positions the dog at the entrance/exit of the graze and sends the dog to gather the stock from the graze and returns to the road to continue the course.
9. Difficult Passage 2: Bridge: Handler and dog take the flock across the bridge.
 - a. STARTED – is not judged on difficult passages, but should consider the bridge to be part of road.
 - b. INTERMEDIATE – The handler may go to the edge of the bridge, but may not lead the flock. Handler follows behind the flock until after the bridge is crossed.
 - c. ADVANCED – The handler must go no further than the edges of the bridge and must remain there until the dog pushes the stock through the bridge, whereupon the handler may move.
10. Passage of the Car: Advanced only - Stock should be “leaned on a fence” during a car pass. (ie: fence, stock dog , car)

STARTED & INTERMEDIATE handlers will turn off the traffic road onto the narrow road returning to the silver gate. The livestock is moved through the 2 gates (from the trap into the lane, then from the lane into the PT).

11. Stop/ Difficult Passage (ADVANCED only) will first stop the flock at the intersection of the traffic & narrow road, then proceed down the fence line to the SE corner of the field, turn north and moving along the fence proceed to the back and through the free standing pen and rejoin the road. The flock must stay within 12 ft of the fence or on the road.
12. (5 pts) Reopen – The flock is moved from the PT boundary arena to the corral gate. The handler and dog reopen the flock into the corral.

Tie breaker #1 – conduct and maneuvers

Tie breaker #2 – overall work

STARTED Maximum points 75

INTERMEDIATE maximum points 100

ADVANCED maximum points 150

AGREEMENT

I (we) agree that the club holding this event has the right to refuse this entry for cause which the club shall deem sufficient. In consideration of the acceptance of this entry and of the holding of this event and of the opportunity to have the dog judged and to win prizes, ribbons, or trophies, I (we) agree to hold the BSCA, the event-giving club, their members, directors, governors, officers, agents, superintendents or event secretary and the owner and/or lessor of the premises and any provider of services that are necessary to hold this event and any employees or volunteers of the aforementioned parties, and any BSCA approved judge, judging at this event, harmless from any claim for loss or injury which may be alleged to have been caused directly or indirectly to any person or thing by the act of this dog while in or about the event premises or grounds or near any entrance thereto, and I (we) personally assume all responsibility and liability for any such claim; and I (we) further agree to hold the aforementioned parties harmless from any claim for loss, injury or damage to this dog.

Additionally, I (we) hereby assume the sole responsibility for and agree to indemnify, defend and save the aforementioned parties harmless from any and all loss and expense (including legal fees) by reason of the liability imposed by law upon any of the aforementioned parties for damage because of bodily injuries, including death at any time resulting therefrom, sustained by any person or persons, including myself (ourselves), or on account of damage to property, arising out of or in consequence of my (our) participation in this event, however such, injuries, death or property damage may be caused, and whether or not the same may have been caused or may be alleged to have been caused by the negligence of the aforementioned parties or any of their employees, agents, or any other persons.

I (WE) AGREE THAT ANY CAUSE OF ACTION, CONTROVERSY OR CLAIM ARISING OUT OF OR RELATED TO THE ENTRY, EXHIBITION OR ATTENDANCE AT THE EVENT BETWEEN THE BSCA AND MYSELF (OURSELVES) OR AS TO THE CONSTRUCTION, INTERPRETATION AND EFFECT OF THIS AGREEMENT SHALL BE SETTLED BY ARBITRATION PURSUANT TO THE APPLICABLE RULES OF THE AMERICAN ARBITRATION ASSOCIATION. HOWEVER, PRIOR TO ARBITRATION ALL APPLICABLE BSCA BYLAWS, RULES, REGULATIONS AND PROCEDURES MUST FIRST BE FOLLOWED AS SET FORTH IN THE BSCA CHARTER AND BYLAWS, RULES, REGULATIONS, PUBLISHED POLICIES AND GUIDELINES.

Permission is granted to duplicate or photocopy for American Kennel Club authorized events only.

AHN999 (8/05)



**It is now possible to enter RTN Herding Trials
On-line from our secure website!**

www.ranchoterranorte.com

Click on the online store tab!









Home of the
Northern Colo Herding Co-op

**OFFICIAL ENTRY FORM
BELGIAN SHEEPDOG CLUB OF AMERICA
Rancho Terra Norte'
1227 East County Rd. 82, Wellington, CO 80549**

Sunday, April 30, 2017 – Event #2017BSCA10 Judge: Ken Theus, DVM

Entry fee: \$60.00 per entry of a dog in each Trial Class (BSCA Recording fee of \$10/entry is included in this fee). Entries close 30 minutes prior to the first handlers meeting of the trial on May 1, 2016 or when numerical limit has been reached. Special deliveries must be marked **No Signature Required**. Mail entries with fees to: Val Manning 1227 E County Road 82, Wellington CO 80549. Online entries accepted on www.ranchoterranorte.com

Make checks or money orders payable to:

Rancho Terra Norte'

Entry fees

--

IMPORTANT: Read reverse side before completing.

Enclosed:

Breed and/or Variety:	Sex:	Date of birth:
Trials: Started___ Intermediate___ Advanced___	Course/Livestock: French Course sheep:_____	
Full name of dog:		
<input type="checkbox"/> BSCA Reg. No. <input type="checkbox"/> AKC Litter No. <input type="checkbox"/> ILP No. <input type="checkbox"/> FSS No. <input type="checkbox"/> Foreign No. & List Country:	Call name of dog:	
Sire:		
Dam:		
Breeder:		

Please Print

Actual Owner(s):		
Owner's address:		
City:	State:	Zip:
Name of Owner's Agent/Handler:		
Agent/Handler's Address:		
City:	State:	Zip:

I (we) agree to abide by the "Agreement" printed on the reverse side of this entry form.
SIGNATURE of owner or agent
duly authorized to make this entry: _____

TELEPHONE # _____

E-MAIL Address (entry questions and/or wait list info may be sent to this e-mail address)

--